

FOCAL/RENAULT

INSTALLATION OF LIVE/PREMIUM KITS FOR
Megane 4 - *April 2018*



FOCAL *INSIDE*

RECOMMENDATIONS BEFORE INSTALLATION

Reset all car radio audio settings:

- Ambience = Natural
- Bass / Midrange / Treble settings = 0
- Loudness = OFF
- Fader and Balance = Centred

The speaker drivers require a break-in period (approximately 20 hours) before they reach optimal sound quality. Start with tracks without too much low frequencies at a low volume. Then turn the sound up little by little.

After this break-in period, you can fine-tune the audio settings as you please.

I - UNBOXING AND LOCATION OF PARTS

IFRA165-4.1

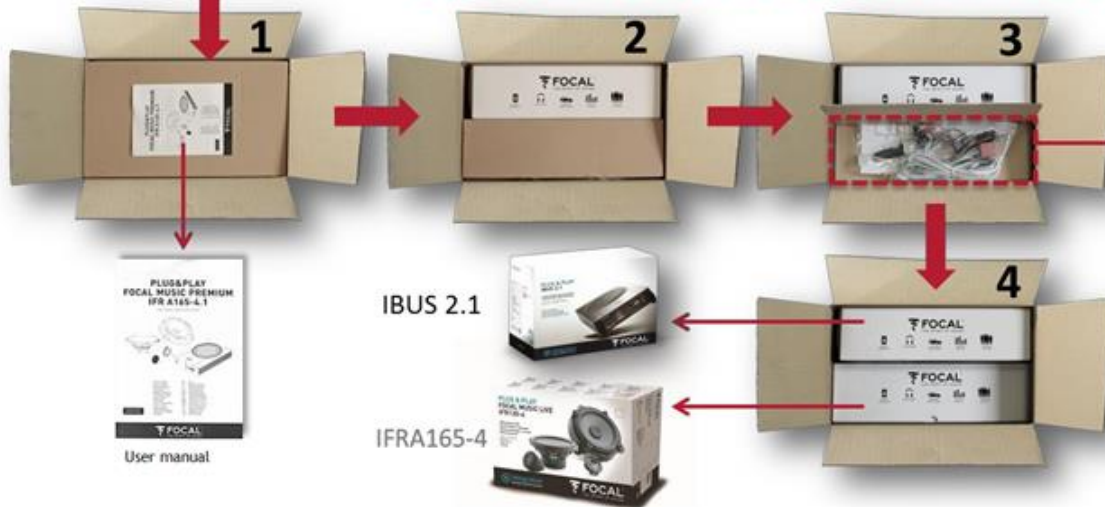

FOCAL[®]INSIDE

I - UNBOXING AND LOCATION OF PARTS

Ibus 2.1

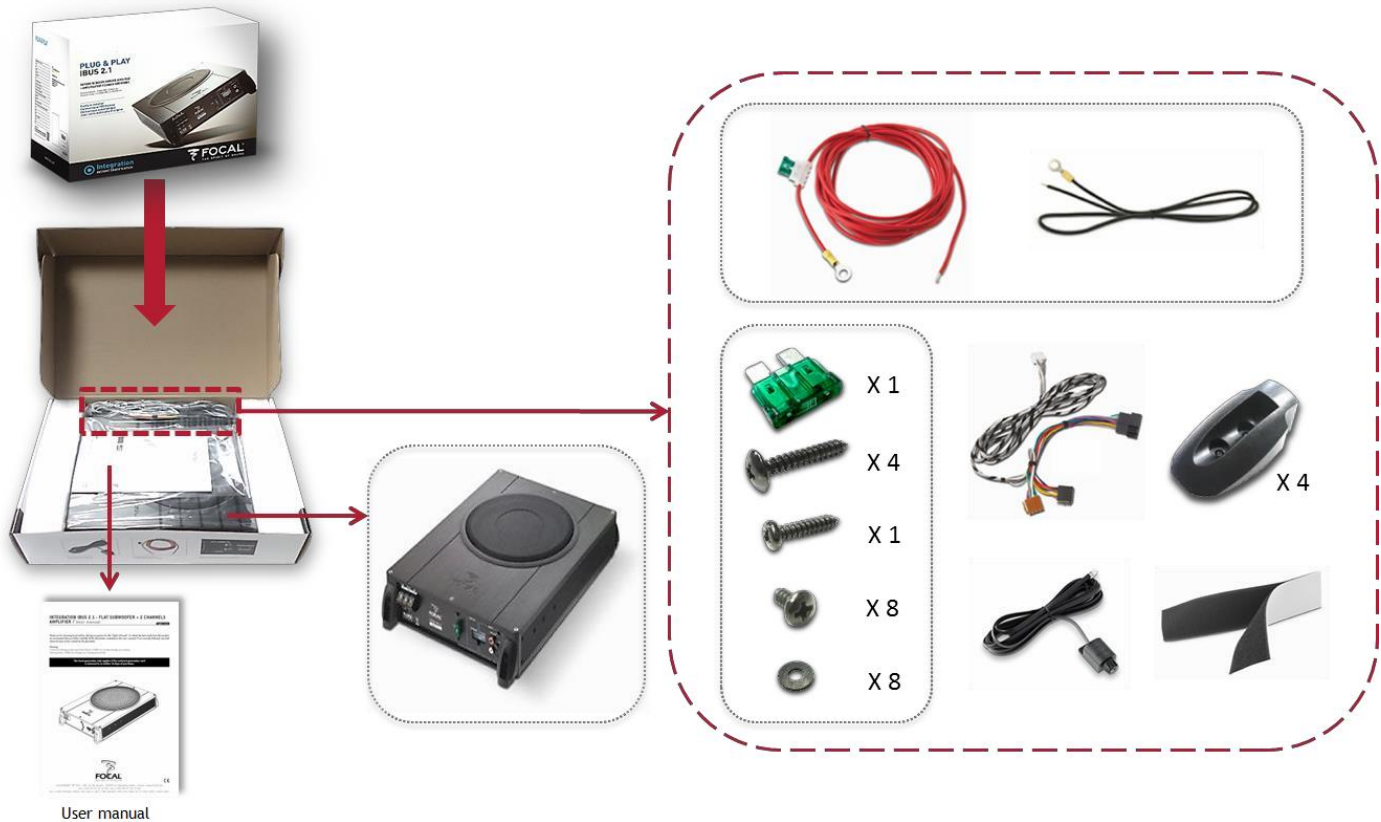

I - UNBOXING AND LOCATION OF PARTS

IFRA165-4

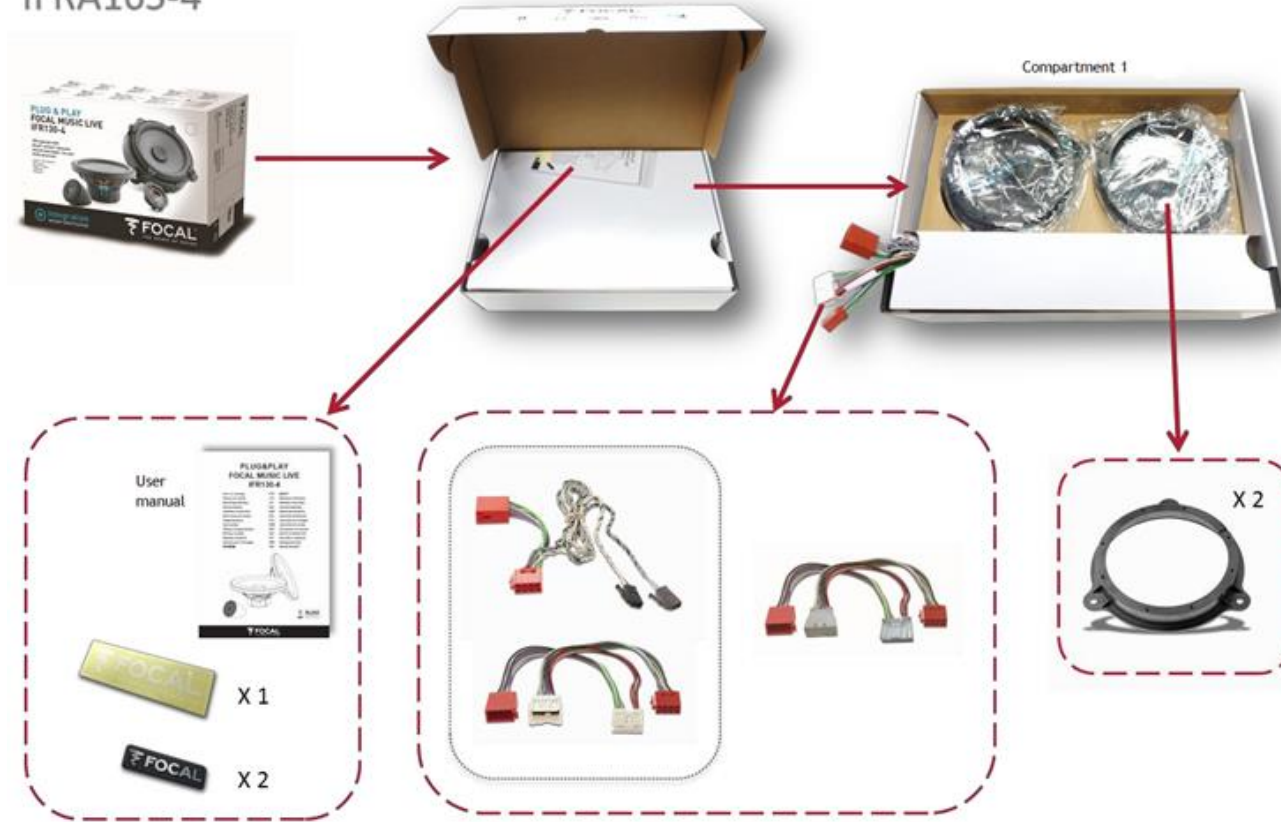

FOCAL INSIDE

I- UNBOXING AND LOCATION OF PARTS

IFRA165-4

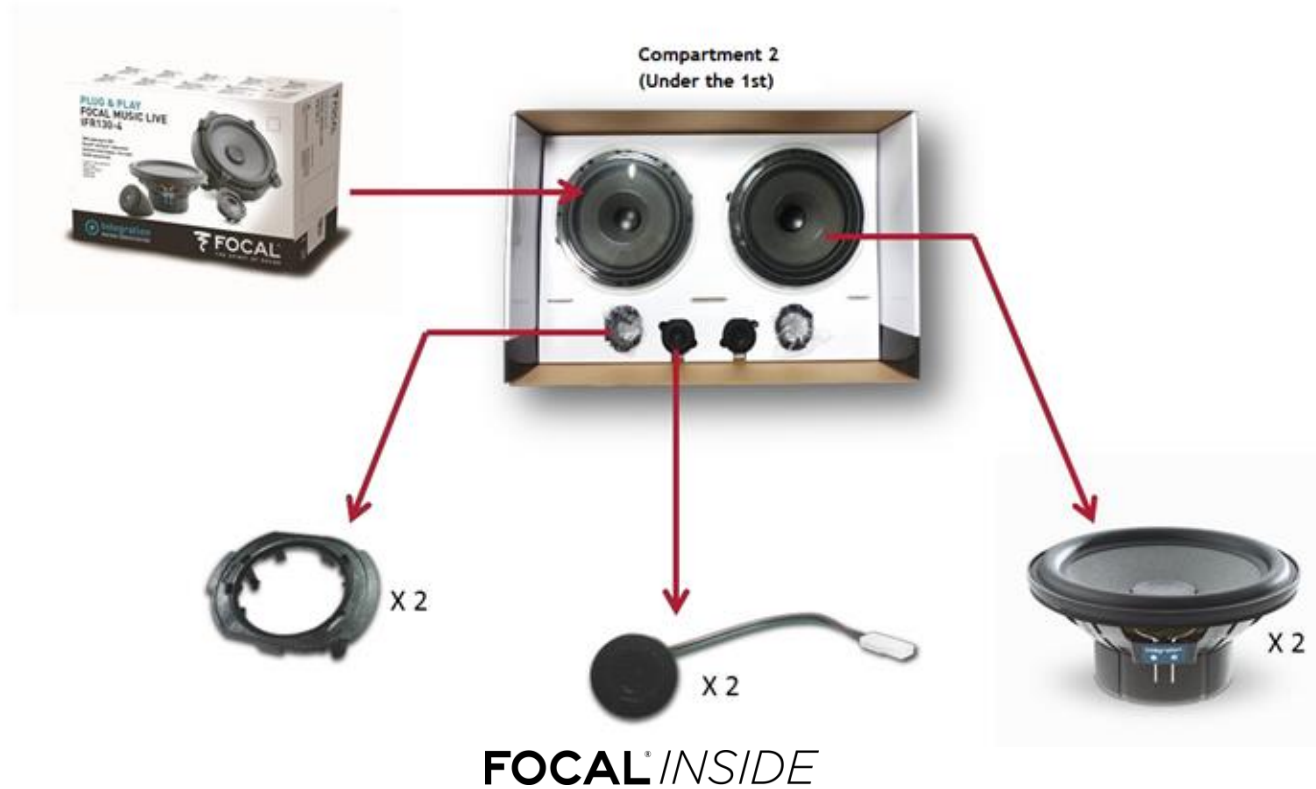

I - UNBOXING AND LOCATION OF PARTS

IFRA165-4

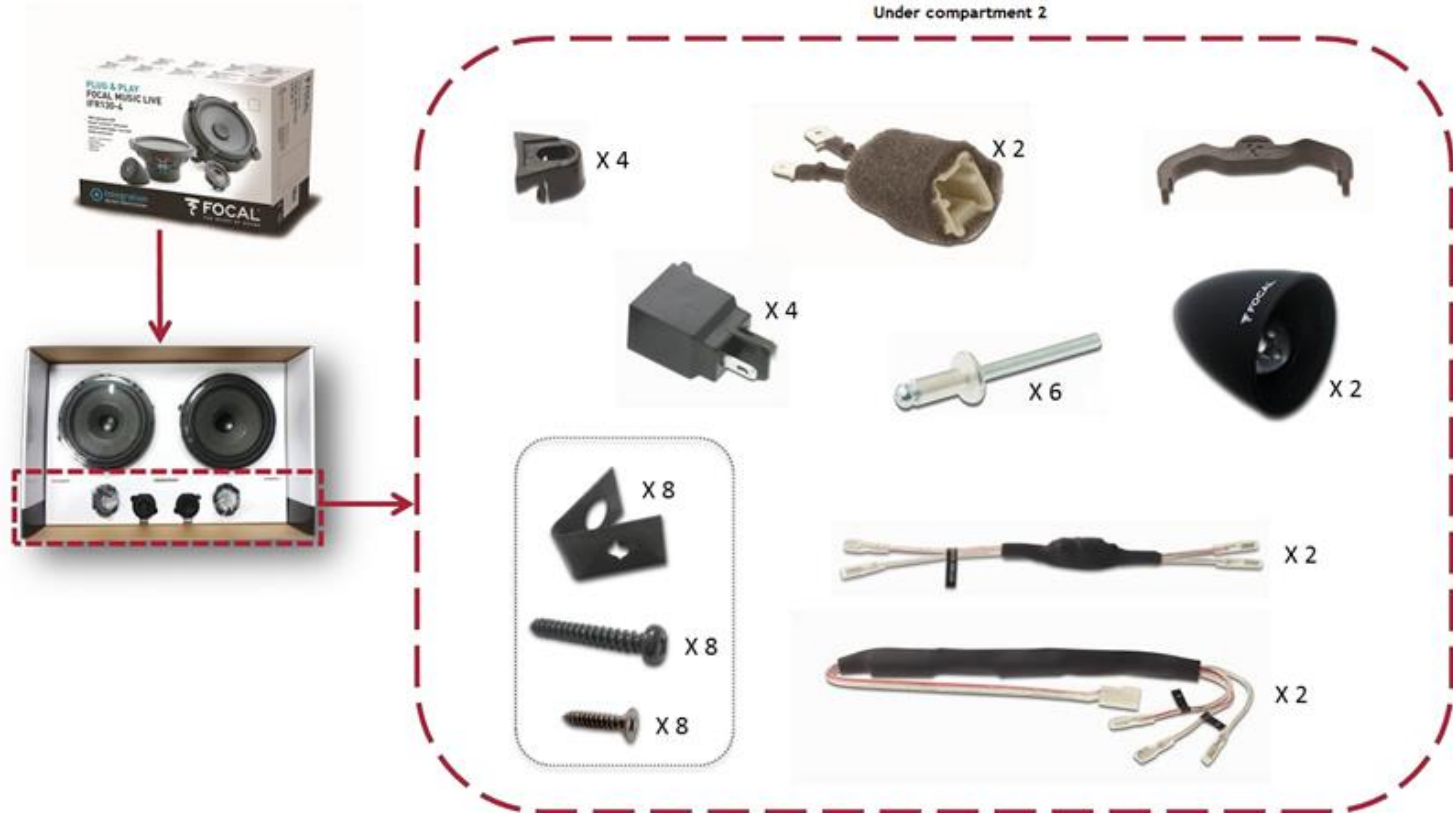

FOCAL *INSIDE*

II - ASSEMBLING THE FRONT SPEAKER DRIVERS

1. Equipment required for assembling the woofer



II - ASSEMBLING THE FRONT SPEAKER DRIVERS

2. Connections

a. Insert the cable into the notch



b. Before you screw, make sure that the two logos are aligned



c. Screw the 4 screws



D. Block the crossover



III - ASSEMBLING THE FRONT SPEAKER DRIVERS

1. Unclip the frontdoor panel

a. Unclip and unscrew then remove the frontdoor panel

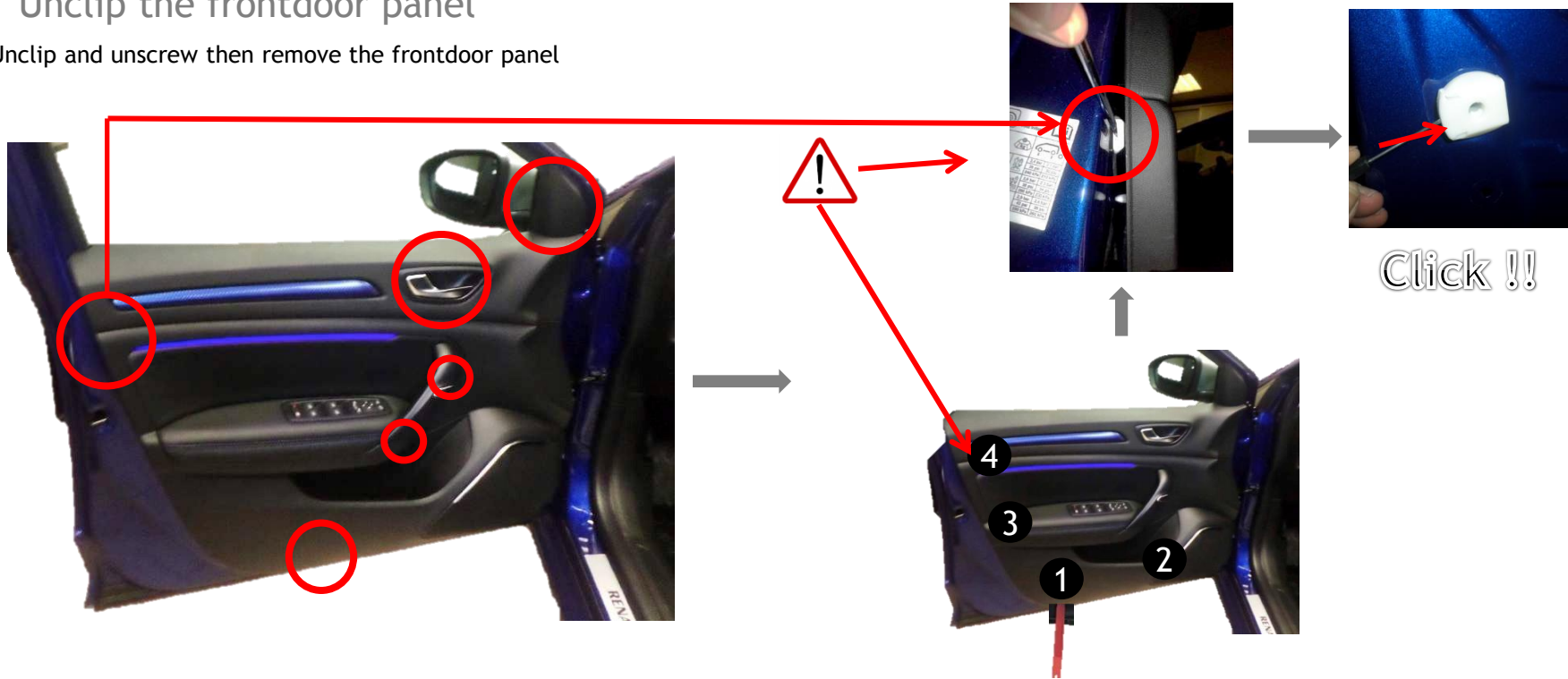

III - ASSEMBLING THE FRONT SPEAKER DRIVERS

2. Remove the original speaker driver

a. Pierce the 3 rivets' head.

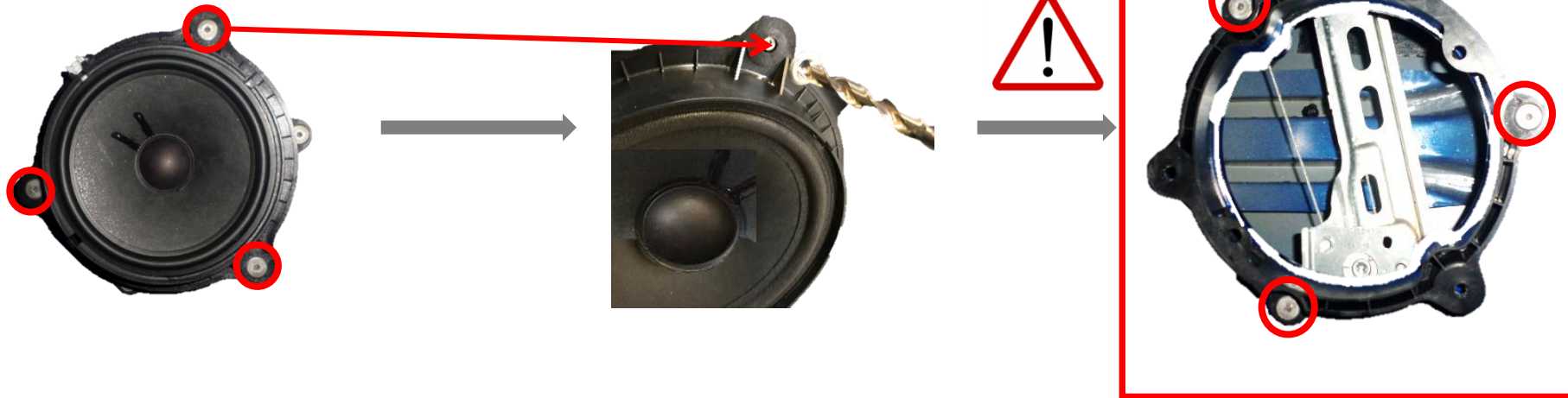

III - ASSEMBLING THE FRONT SPEAKER DRIVERS

3. Installing the front speaker drivers

a. Rivet on the door frame and connect the Focal speaker driver.



Note : Some version may use screws. If so, do not use the rivet

IV - ASSEMBLING THE TWEETER

1. Equipment required for assembling the tweeter

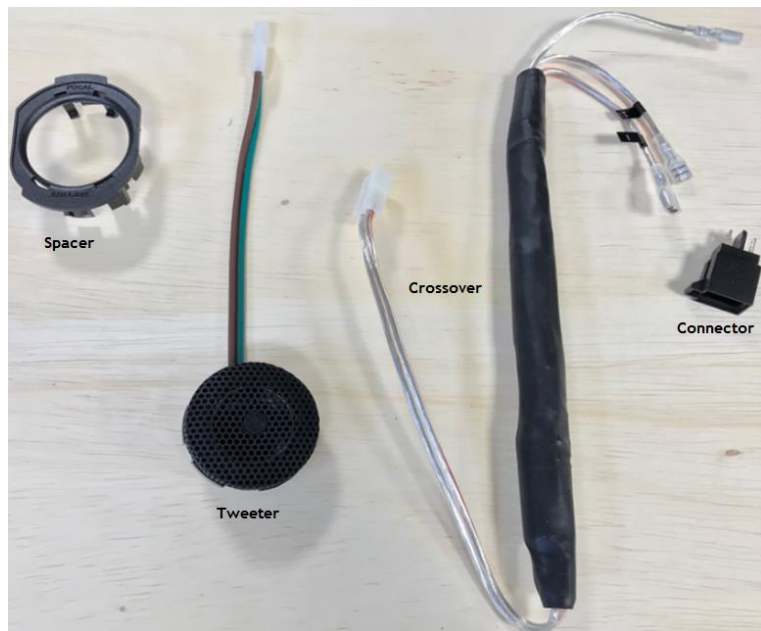

2. Remove the tweeter's grille by simply unclipping it

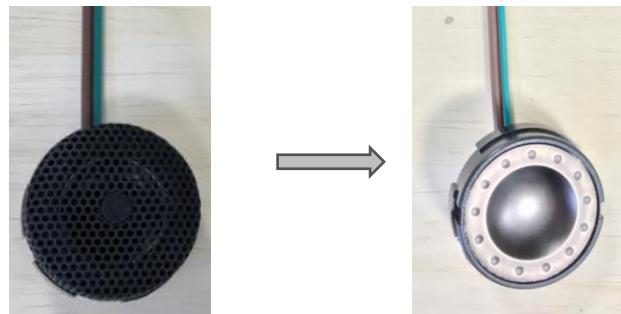

IV - ASSEMBLING THE TWEETER

3. Slot the tweeter into the spacer making sure it's the right way up

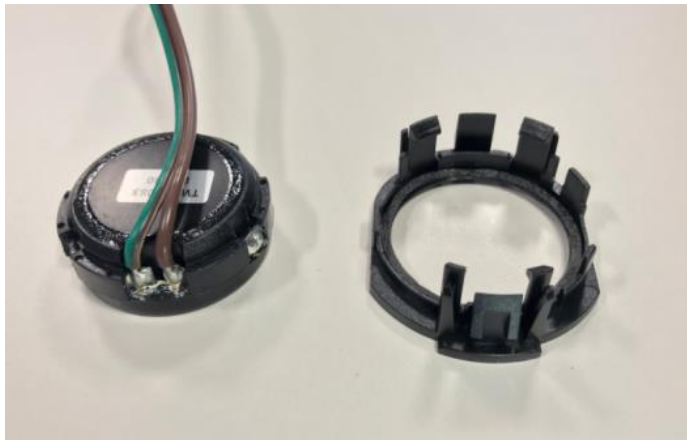

Note: Dispose the parts in this very position.

4. Connect at position 2



Note: Position 1 is not used in this set up

V - INSTALLING THE TWEETER

- 1 Remove the tweeter grille



- 2 Remove the tweeter



V - INSTALLING THE TWEETER

- 3 Insert the crossover and connect it

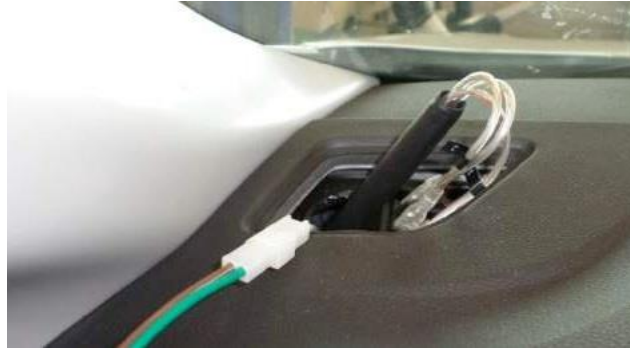

- 4 Clip the tweeter into its housing then the grille



V - ASSEMBLING THE FRONT SPEAKER DRIVERS

1. Equipment required for assembling the woofer



V - ASSEMBLING THE FRONT SPEAKER DRIVERS

2. Connections

a. Insert the cable into the notch



b. Before you screw, make sure that the two logos are aligned



c. Screw the 4 screws



D. Block the crossover



VI - ASSEMBLING THE REAR SPEAKER DRIVERS

1. Unscrew



2. Remove the door panel

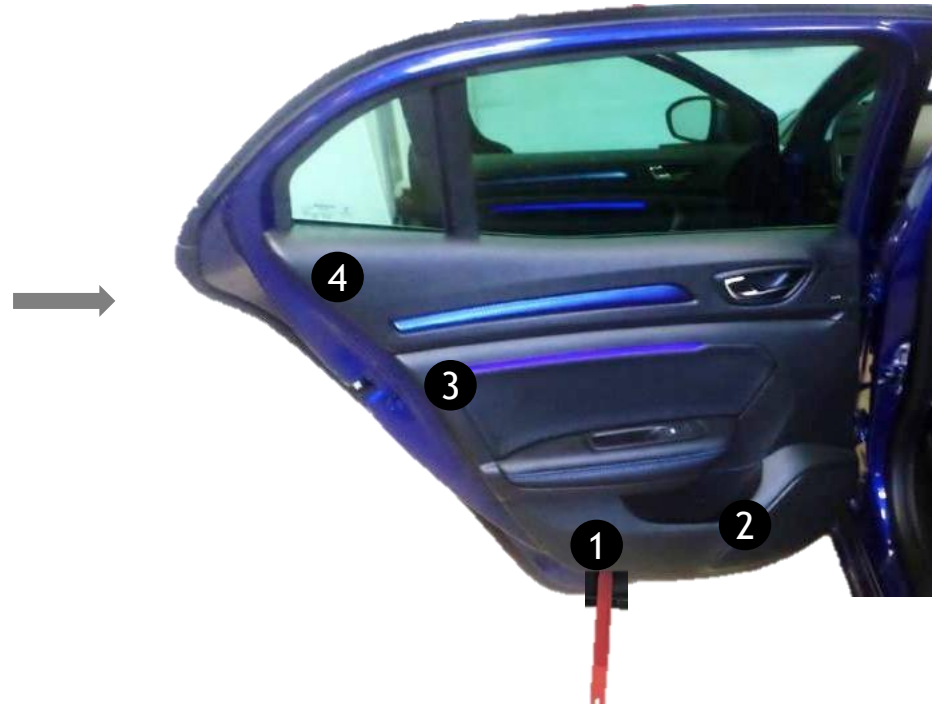

VI - ASSEMBLING THE REAR SPEAKER DRIVERS

2. Remove the original speaker driver

a. Pierce the 3 rivets' head.

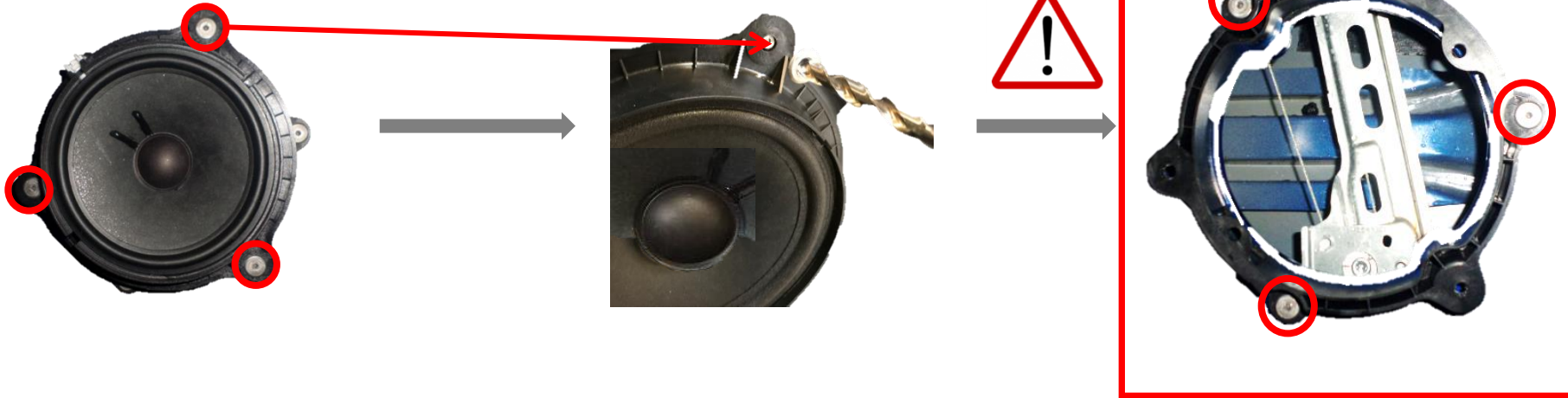

VI - ASSEMBLING THE REAR SPEAKER DRIVERS

4. Installing the front speaker drivers

a. Rivet on the door frame and connect the Focal speaker driver.



Note : Some version may use screws. If so, do not use the rivet

VII - ASSEMBLING THE TWEETER

1. Equipment required for assembling the tweeter

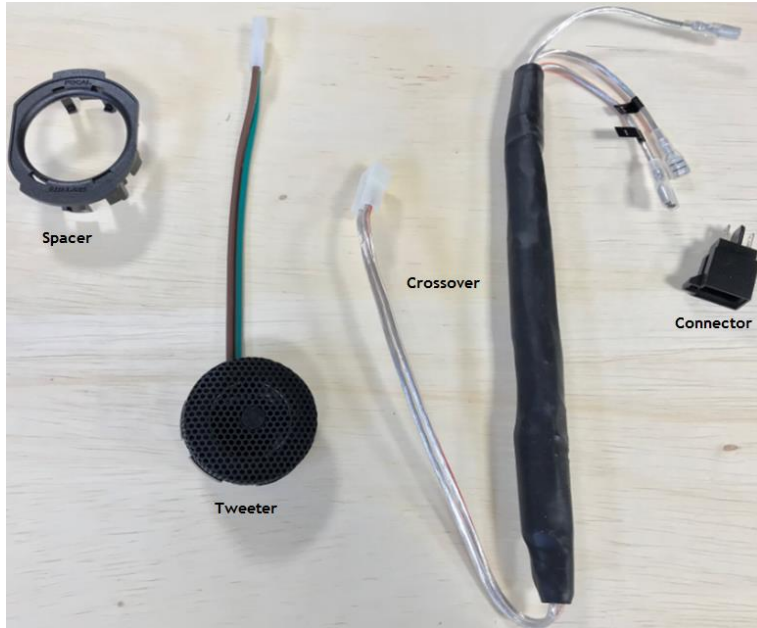

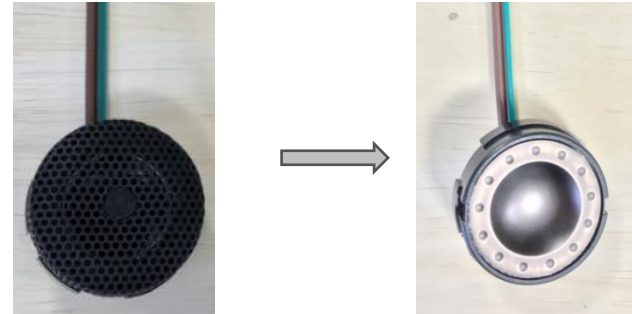

2. Remove the tweeter's grille by simply unclipping it

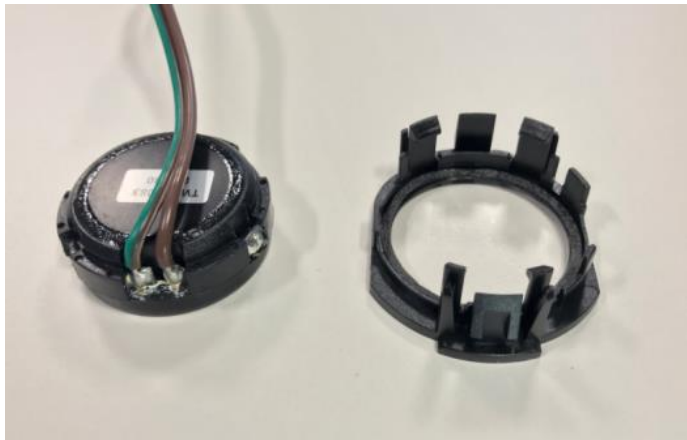

VII - ASSEMBLING THE TWEETER

3. Slot the tweeter into the spacer making sure it's the right way up



 **Note:** Dispose the parts in this very position.

4. Connect at position 2



 **Note:** Position 1 is not used in this set up

VIII - INSTALLING THE REAR TWEETER

1. Connect the crossover to the original connector



Original connector

2. Clip the Focal tweeter



Replaced by :



VIII - INSTALLING THE REAR TWEETER

3. Connect the crossover to the tweeter before putting the door panel back

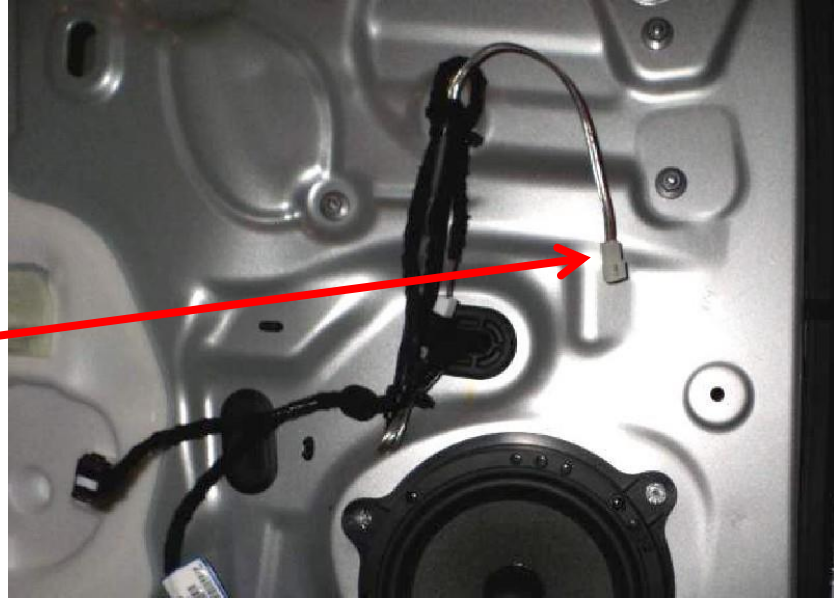

VII - PREPARING THE SUBWOOFER

1. Equipment required for installing the subwoofer

Ground cable



Power cable



Heat shrinkable sleeve

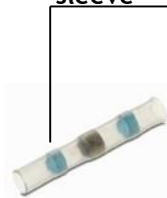

Power connector



Subwoofer cable with remote control



Adapter

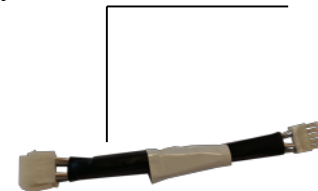

Ibus 2.1



Extension cable



Head unit - subwoofer interconnect cable



Hook-and-loop fasteners (e.g. Velcro®)



Connectors



VII - PREPARING THE SUBWOOFER

1. Prepare subwoofer cable assembly

a. Remove the fuse and pod

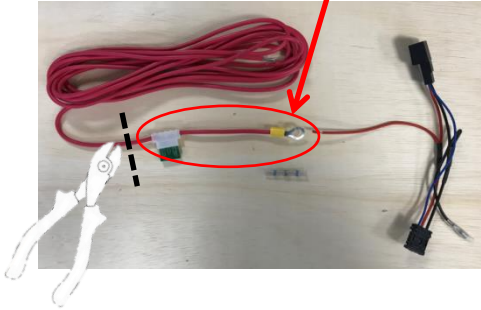

b. Place the heat shrinkable sleeve over the stripped parts of the cables.

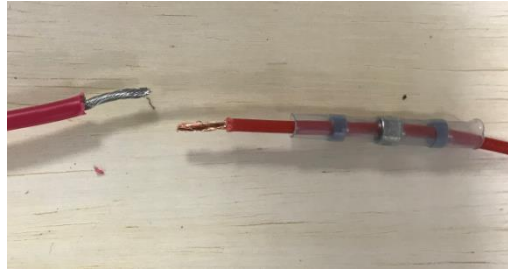

c. Use a heat gun to heat the heat shrinkable sleeve.

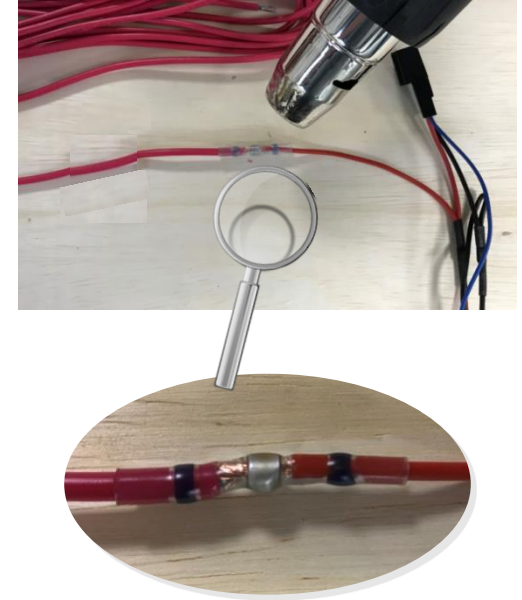

VII - PREPARING THE SUBWOOFER



d. Connect the adapter to the extension cable.

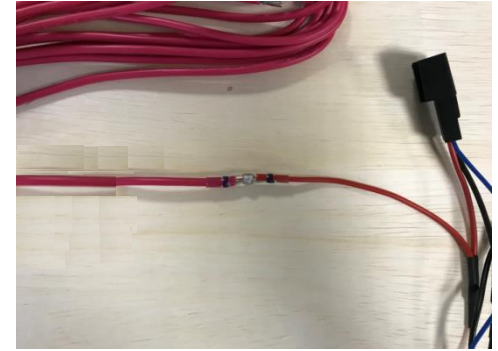

e. Place the subwoofer without connecting it.



f. Tape the cables together every 20 cm.

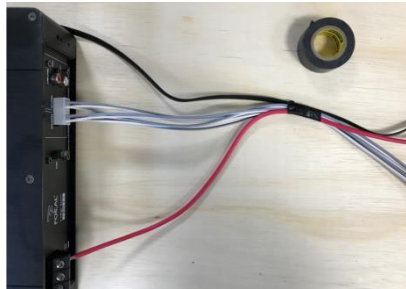

g. Keep slack for the cable's passage on the side of the head unit.

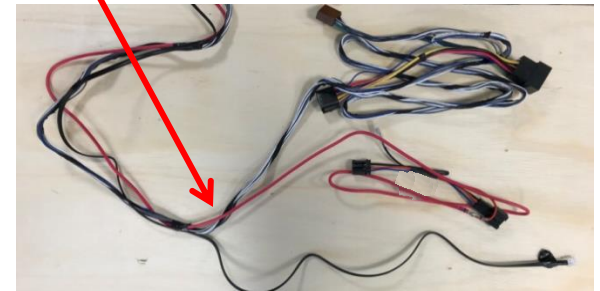

VIII - INSTALLING THE SUBWOOFER

1. Unclip the console's upper part



2. Unplug the two lighted sidebars (if they exist) then remove them



VIII - INSTALLING THE SUBWOOFER

3. Remove the plastic covers on both side



4. Remove the outer part of the head unit

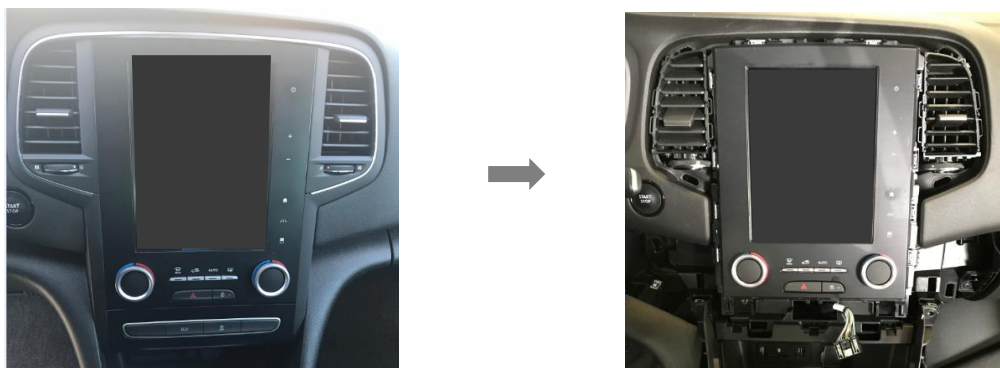

VIII - INSTALLING THE SUBWOOFER

5. Unscrew to push back the console



Note : Unscrew on both side.

VIII - INSTALLING THE SUBWOOFER

6. Push back the console then remove the plastic covers

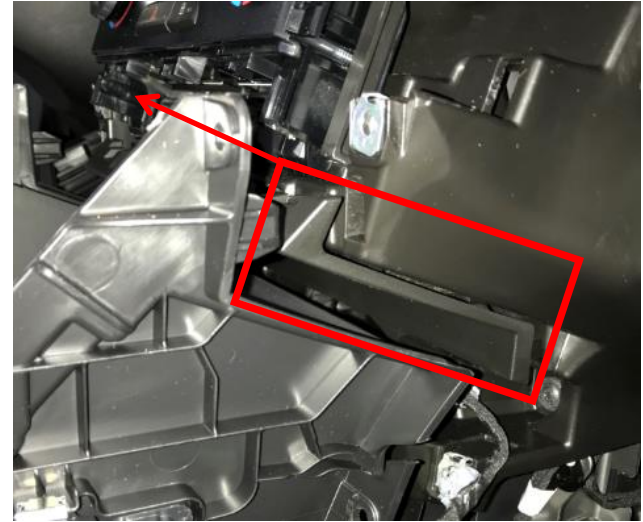

VIII - INSTALLING THE SUBWOOFER

1. Connection to 12 v cigar lighter(front or rear)

1. In the case shown below, rear connection

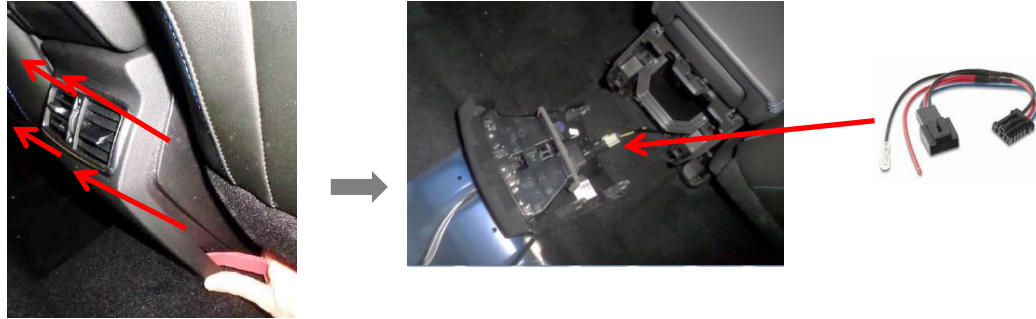

2. Connection to the head unit

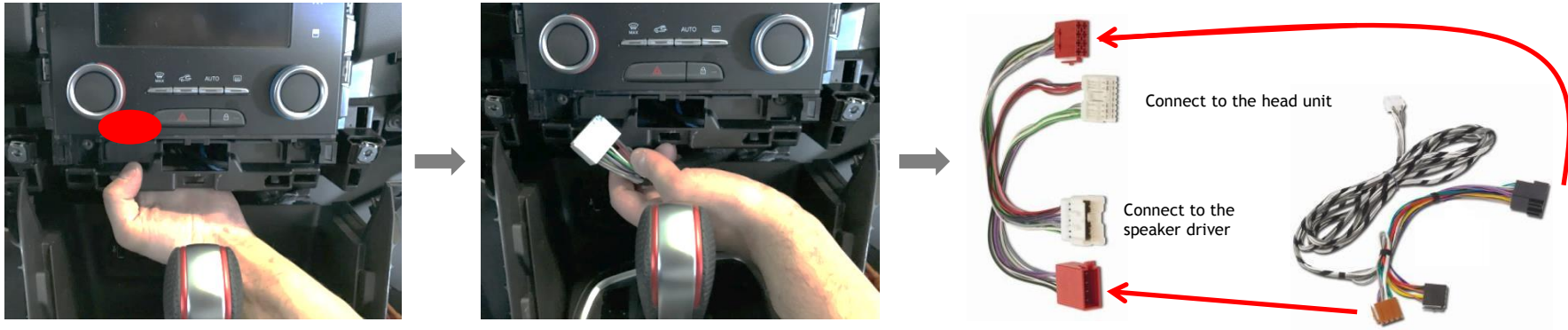

VIII - INSTALLING THE SUBWOOFER

2. Passageway of the wires from front to rear



Note : Fix the remote with some Velcro® (advised).

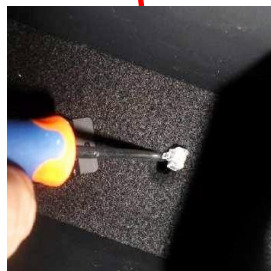

Note : fix the wires under the carpet from the console's exit

VIII - INSTALLING THE SUBWOOFER

3. Ground wire connection(black wire)

- a. Connect the ground wire to the rear ground slot

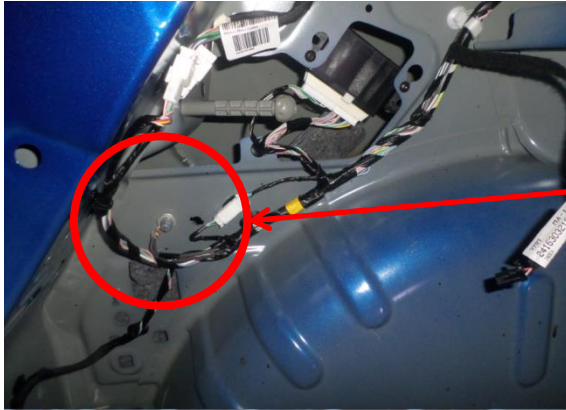

VIII - INSTALLING THE SUBWOOFER

4. Subwoofer positioning

- a. Position the subwoofer behind the backseat on the left (It is advised to screw the subwoofer with the provided screws and rubber pads)



Note : Fix the subwoofer with the provided Velcro®.



VIII - INSTALLING THE SUBWOOFER

b. Connect (rear)



c. Connect (front - remote)



VIII - INSTALLING THE SUBWOOFER

d. Subwoofer settings.

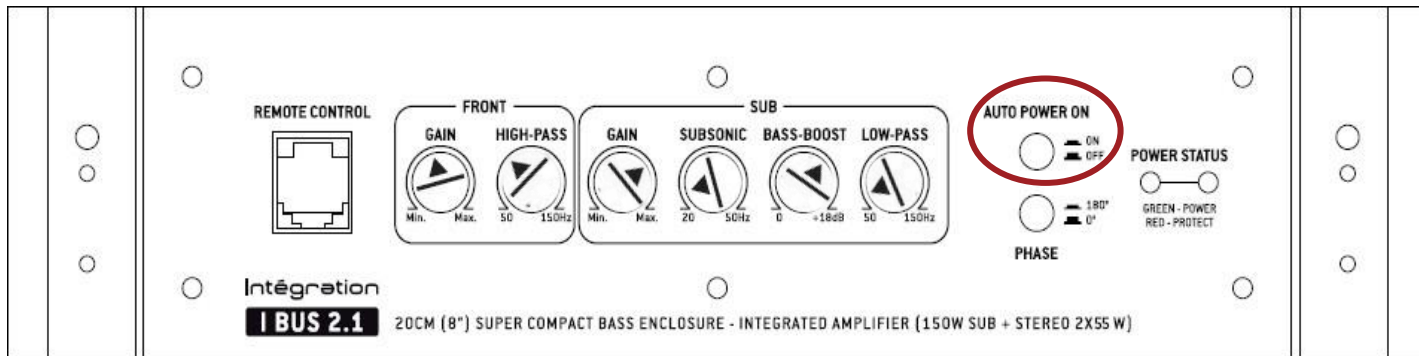

Auto Power = ON
Phase = 0°

IX - ACCESSORIES

a. Stickers : Put the provided stickers on to the tweeter's grille.



a. Front



b. Rear



FOCAL[®] *INSIDE*

www.focal-inside.com